

WHELEN MBV2 COMBO LED

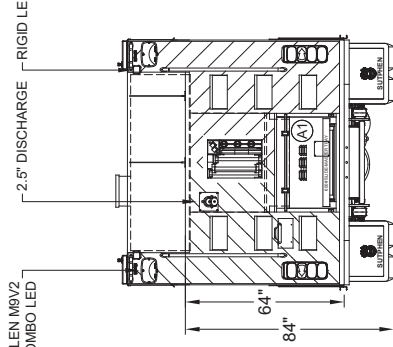

LADDER CHUTE
 (1) 24" 2-SECT.
 (1) 14' ROOF
 (1) 10' FOLDING
 (1) BACKBOARD STOR
 (3) PIKE POLE STOR

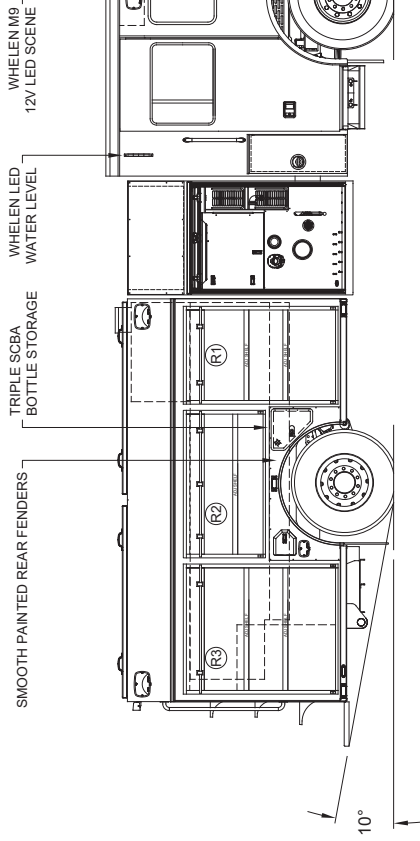

COMPT	DOORS	OPENING DIMENSIONS	INSIDE DIMENSIONS	VOLUME
L1	ROLL-UP	37.5"W X 55.4"H	43.1"W X 66" X 25.9"D	38.7 CU. FT.
L2	ROLL-UP	61"W X 52.8"H	61"W X 66" X 25.9"D	42.8 CU. FT.
L3	ROLL-UP	59.5"W X 52.8"H	53.3"W X 66" X 25.9"D	42.8 CU. FT.
H1	LIFT-UP	(2) 19.25"W X 70.25"	161.6"W X 17.3"H X 12.9"D	20.9 CU. FT.

COMPT	DOORS	OPENING DIMENSIONS	INSIDE DIMENSIONS	VOLUME
R1	ROLL-UP	37.5"W X 55.4"H	43.1"W X 66" X 25.9"D	38.7 CU. FT.
R2	ROLL-UP	61"W X 52.8"H	61"W X 66" X 25.9"D	42.8 CU. FT.
R3	ROLL-UP	59.5"W X 52.8"H	53.3"W X 66" X 25.9"D	42.8 CU. FT.
H2	LIFT-UP	(2) 19.25"W X 70.25"	161.6"W X 17.3"H X 12.9"D	20.9 CU. FT.

COMPT	DOORS	OPENING DIMENSIONS	INSIDE DIMENSIONS	VOLUME
A1	ROLL-UP	37.5"W X 30.8"H	40"W X 28" H X 31"D	21.6 CU. FT.
				TOTAL: 293.4 CU. FT.

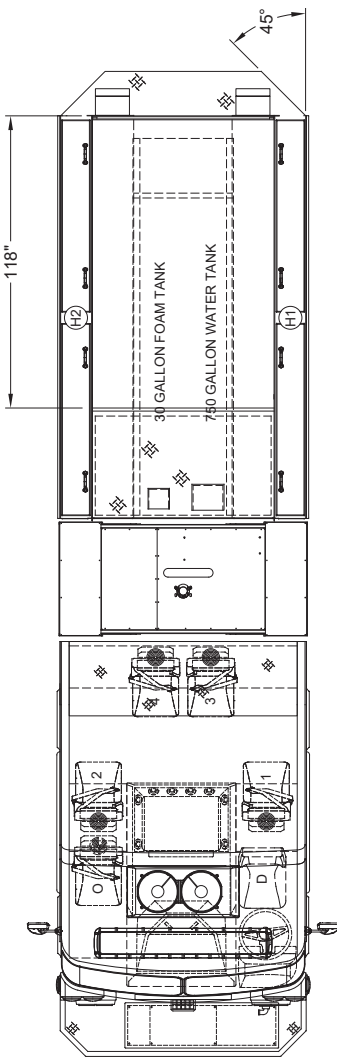

PAINT SCHEME
 SINGLE TONE RED

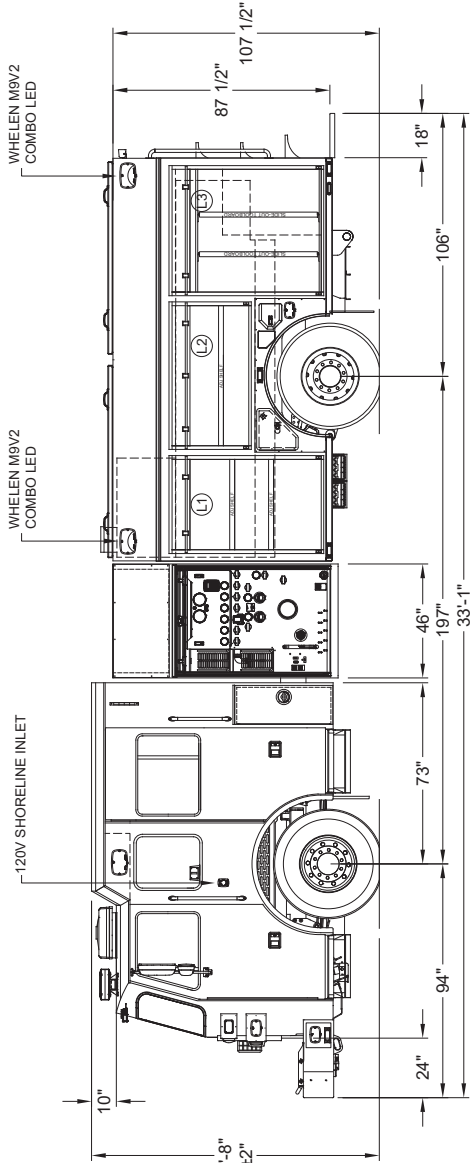
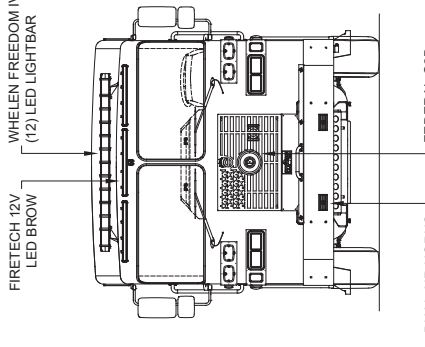

SUTPHEN
 DEMO 494
 NORTHEAST
 PROGRAM 2/PUMPER
 DWS. NO. HS-6914

REV. E	REV-E SHOP ORDER (REVISED PUMP PANEL LIGHTING)	DESCRIPTION	DATE	BY
REV. F	REV-F SHOP ORDER (REVISED HOSE BED & WATER TANK)		11/17/20	KG
REV. G	REV-G SHOP ORDER (CHANGED PAINT ON THE FRAME RAILS & BODY REAR DROP FROM RED TO BLACK)		11/17/20	KG
REV. H	REV-H SHOP ORDER (ADDED ENG NOTES FOR THE MECH SIREN)		01/13/21	KG

DIMENSIONS SHOWN ON THIS DRAWING ARE APPROXIMATE AND ARE SUBJECT TO MINOR DEVIATIONS DURING CONSTRUCTION.
 IN THE EVENT OF A DISCREPANCY BETWEEN THE SUTPHEN SPECIFICATIONS AND DRAWING, THE SUTPHEN SPECIFICATIONS SHALL PREVAIL.
 DRAWING IS FOR REFERENCE ONLY. SOME ITEMS PROPOSED MAY NOT BE SHOWN OR NOTED.

NAME: _____
 TITLE: _____
 DATE: _____

CUSTOMER APPROVAL

THIS PRINT IS PROVIDED ON A RESTRICTED BASIS AND IS NOT TO BE USED IN ANY WAY DETRIMENTAL TO THE INTEREST OF SUTPHEN CORPORATION.